

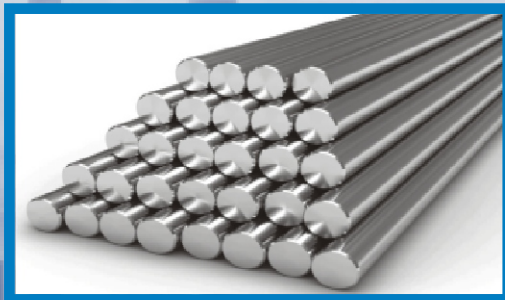

ISO 9001 : 2015
ISO 14001 : 2015
OHSAS 18001 : 2007
CERTIFIED Co.

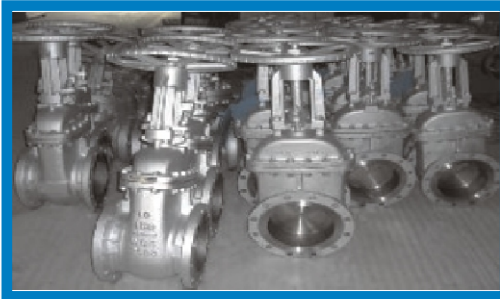

Pacific Steel Overseas

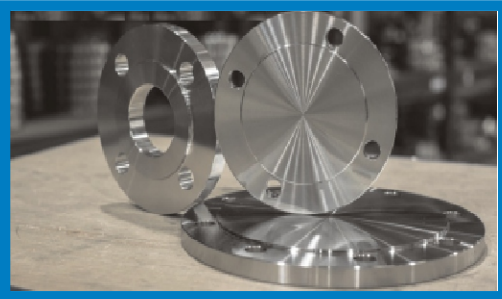

..... Email : export@pacificsteel.in / sales@pacificsteel.in

Website : www.pacificsteel.in



Pacific Steel Overseas

Company Profile

There are infinite factors and conditions which contribute to achievement of **SUCCESS** of a trading business namely the right product mix, a broad knowledge of products & their applications, good business relations, logistics & financial expertise, close customer interaction and last but not least appropriate range of support service at PACIFIC STEEL OVERSEAS these have been accomplished to create excellent dimension.

Formed by a group of young professionals, PACIFIC STEEL OVERSEAS is one of the leading Manufacturers, Exporters & Suppliers of Stainless Steel, Carbon Steel, Alloy Steel, Copper, Brass lead, Aluminium, Monel, Inconel, Hastalloy, as per international ANSI standards.

Our Products range include :

- ➔ **Pipe and Tubes : In seamless & welded in all grades.**
- ➔ **BW/SW/SCRD Pipe Fittings :** Such as Elbow, Return Bend, Straint and Reducing Tee, Crosses, Lap joint Stubend, Reducers, Unions, Caps, Bush, Plug, Nipples, Couplings, Thredolets, Weldolets, Elbowlets Etc.
- ➔ **Flanges :** Such as WNRF, SORF, SOFF, BLRF, SWRF, LAP JOINT, etc.
- ➔ **Tube Fittings & Ferrules Fittings**
- ➔ **Fasteners :** Such as nuts, bolts, studs, washers and gaskets, etc.
- ➔ **Rods, Strips, Sheets, Plates, Coils, Flat, Circle, etc.**

We are approved suppliers to various Government Departments & Public Sector all over the country and have been regularly supplying them from a long time. We have ready stocks of the above items in various sizes as per National / International standards and specifications. The same shall be supplied as per your requirements and that to a very reasonable rates. We can arrange any third party inspection agency like LRIS, BVIS, IBR, TUV, DNV, MECON, MDL, etc.

As we are very much interested to do business with valuable clients like you on long terms basis. we request you to please enlist our name in your approved vendor list and sed us your valued purchase enquires so as to enable us to quote our most competitive rated and terms.

Quality Policy

Our quality assurance programme is documented in an approved quality assurance manual and covers all manufacturing, sales & service procedures. Stringent control of dimension and mechanical properties starting from the raw material and following right through all production steps to laboratory test as the final product is exercised in order to maintain the high quality fo products.

The qualify assurance system assures every product to go through the following Quality systems.

- ➔ **Materiel Control System**
- ➔ **Process Control System**
- ➔ **Machining & Dimensional Control**
- ➔ **Certification & Supplementary Test**
- ➔ **Finishing & Marking**





Pacific Steel Overseas

Product Range

PIPES



Stainless Steel : ASTM A312 TP 304/ 304L/ 304H / 316/316L/317/317L/321/310/347/904L etc.

Carbon Steel : ASTM A53 GR. B/A106 GR. B/API 5L GRADE B/ API 5L GR. X42/46/52/56/60/56/70A333 GR. 3/GR. 6 etc.

Alloy Steel : ASTM A335 GR. P1/ P5/ P9/ P11/ P22/ P91 etc.

Others : Duplex, Super Duplex, Monel, Nickel, Inconel, Hastalloy, Copper, Brass, Bronze, Titanium, Tantalum, Bismuth, Aluminium, High Speed Steel, Zinc, Lead, etc.

Types : Round, Square, Rectangular,

Size : Up to 24" NB (Seamless & Welded)

Wall Thickness : Sch. 5S to Sch. XXS

BUTT WELD FITTINGS

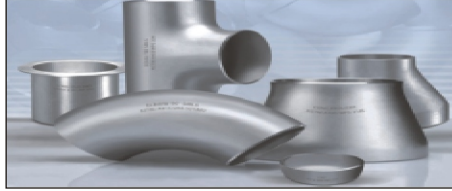

Stainless Steel : ASTM A403 WP 304/ 304L/ 304H / 316/316L/317/317L/321/310/347/904L etc.

Carbon Steel : ASTM A234 WPB/ A420.WPL3/ A420 WPL6/ MSS-SP-75 WPHY 42/ 46/ 52/ 56/ 60/ 70 etc.

Alloy Steel : ASTM A234 Wp1/ Wp5/ Wp9/ Wp11/ Wp22/Wp91 etc.

Others : Duplex, Super Duplex, Monel, Nickel, Inconel, Hastalloy, Copper, Brass, Bronze, Titanium, Tantalum, Bismuth, Aluminium, High Speed Steel, Zinc, Lead, etc.

Types : Elbow, Tee, Reducer, Return Bends, Stub-Ends, Cap, Collar, Cross, Insert etc.

Size : 1/4" NB TO 32" NB (Seamless & Welded)

Wall Thickness : Sch. 5S to Sch. XXS

SCREWED & FORGED FITTINGS



Stainless Steel : ASTM A182 F304/ 304L/ 304H / 316/316L/317/317L/321/310/347/904L etc.

Carbon Steel : ASTM A105/ A694 F42/ 46/ 52/ 56/ 60/ 65/ 70/ A350 Lf3/ A350 LF2 etc.

Alloy Steel : ASTM A182 F1/ F5/ F9/ F11/ 22/ F91 etc.

Others : Duplex, Super Duplex, Monel, Nickel, Inconel, Hastalloy, Copper, Brass, Bronze, Titanium, Tantalum, Bismuth, Aluminium, High Speed Steel, Zinc, Lead, etc.

Types : Elbow, Tee, Unin, Cross, Coupling, Cap, Bshing, Plug, Swage, Nipple, Welding Boss, Hexagon Nipple, Barnal Nipple, Welding Nipple, Parraler Nipple, Street Elbow, Hexagon Nut, Hose Nipple, Bend, Adapter, Insert, Weldolet, Elbowlet, Sockolet, Thredolet, Nipolet, Letrolet etc.

Size : 1/4" NB TO 4" NB (Socketweld & Threaded)

Wall Thickness : 3000#, 6000#, 9000#

FLANGES



Stainless Steel : ASTM A182 F304/ 304L/ 304H/ 316/ 316L/ 317/ 317L/ 321/ 310/ 347/ 904L etc.

Carbon Steel : ASTM A105/ A694 F42/ 46/ 52/ 56/ 60/ 56/ 70/ A350 Lf3/ A350 LF2 etc.

Alloy Steel : ASTM A182 F1/ F5/ F9/ F11/ F22/ F91 etc.

Others : Duplex, Super Duplex, Monel, Nickel, Inconel, Hastalloy, Copper, Brass, Bronze, Titanium, Tantalum, Bismuth, Aluminium, High Speed Steel, Zinc, Lead, etc.

Types : Weldneck, Silpon, Blind, Socket Weld, Lap Joint, Spectacles, Ring, Joint, Oritcae, Long Weldneck, Deck Flange etc.

Size : 1/2" NB TO 24" NB.

Class : 150#, 300#, 400#, 600#, 900# & 2500#

FASTENERS

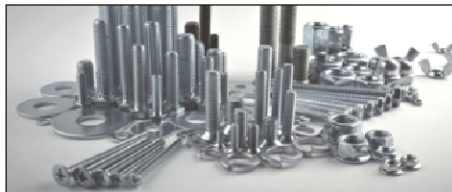

Stainless Steel : AISI 304, 304L, 316, 316L, 310, 317, 317L, 321, 347, 410, 420, 904L etc.

Alloy Steel : 4.6, 5.6, 6.6, 8.8, 10.9 & 12.9 / 'R', 'S', 'T' Conditions.

Carbon Steel : Bare Condition, Galvanized, Phosphetised, Cadium Plated, Hot Deep Galvanized, Bloodied, Nickel Chrome Plated, etc.

Non Ferrous Metal : Duplex, Super Duplex, Copper, Brass, Aluminium, Titanium, Nichrome, Al.Bronze Phosphorous Bronze etc.

Types : Bolts, Nuts, Wahsers, Anchor Fasteners, Stud Bolts, Eye Bolt, Stud, Threaded Rod, Cotter Pin, Socket Screw, Fine Fasteners & Spares, Foundations Fasteners etc.

SHEETS, RODS & PLATES

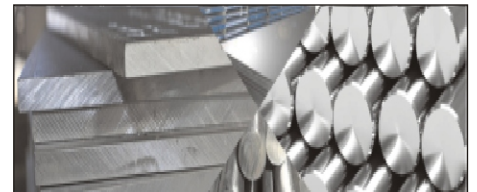

Material Grade : Stainless Steel, Carbon Steel, Alloy Steel, Steam Boiler Quality, Exotic Materials i.e. incoly, Monel, Hastalloy, Cupronickel, Other Ferrous & Non Ferrous Metals.

Material Grades / Standard / Specification :

Stainless Steel : ASTM A182/A240 Tp304/ 304L/ 304H/ 316/ 316L/ 317/ 317L/ 321/ 310

Carbon Steel : A515GR60/70, IS 2062

Alloy Steel : ASTM A182/387F/ P1/ 5/ 9/ 11/ 22/ 91

Others : Duplex, Super Duplex, Monel, Inconel, Hastalloy, Copper, Brass, Bornze, Titanium etc.



Pacific Steel Overseas

BUTT WELDING PIPE FITTING DIMENSIONAL STANDARD ANSI B-16.9, B-16.28 & MS SS P43

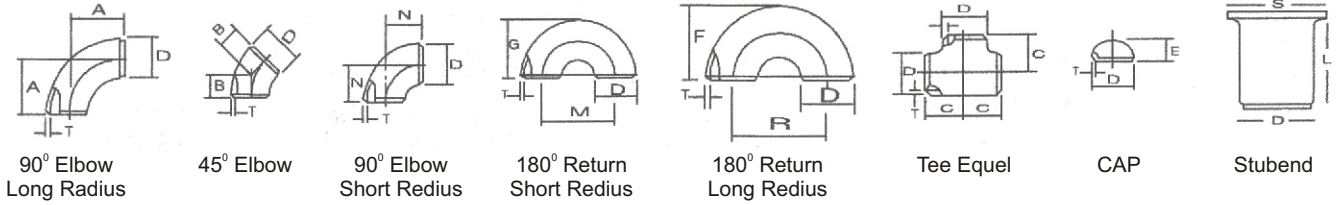

Normal Pipe Size		Outside Diameter	Center to Face				Back to Face			Center to Center			Length 'L' MS SS P43 B 16.9	
Inch.	mm	D	A	B	C	N	E	F	G	R	M	S	L	L
1/2	15	21.3	38.00	16.0	25.0	---	25.0	48.0	—	76.0	—	35.0	50.8	76.2
3/4	20	26.7	29.00	11.0	29.0	—	25.0	43.0	—	57.0	—	43.0	50.8	76.0
1	25	33.4	38.00	22.0	38.0	25.0	38.0	56.0	41.0	76.0	51.0	51.0	50.8	101.6
1.1/4	32	42.2	48.00	25.0	48.0	32.0	38.0	70.0	52.0	95.0	64.0	64.0	50.8	101.6
1.1/2	40	48.3	57.15	29.0	57.0	38.0	38.0	83.0	62.0	114.0	76.0	73.0	50.8	101.6
2	50	60.3	76.00	35.0	64.0	51.0	38.0	106.0	81.0	152.0	102.0	93.0	63.5	152.4
2.1/2	65	73	95.25	44.0	76.0	64.0	38.0	132.0	100.0	191.0	127.0	105.0	63.5	152.4
3	80	88.9	114.30	51.0	86.0	76.0	51.0	159.0	121.0	229.0	152.0	127.0	63.5	152.4
3.1/2	90	101.6	133.35	57.0	95.0	89.0	64.0	184.0	140.0	267.0	178.0	140.0	76.2	152.4
4	100	114.3	152.0	63.0	105.0	102.0	64.0	210.0	159.0	305.0	203.0	157.0	76.2	152.4
5	125	141.3	190.0	79.0	123.0	127.0	76.0	262.0	197.0	381.0	254.0	186.0	76.2	203.2
6	150	168.3	229.0	95.0	143.0	152.0	89.0	313.0	237.0	457.0	305.0	216.0	88.9	203.2
8	200	219.1	305.0	127.0	178.0	203.0	102.0	414.0	313.0	610.0	406.0	270.0	101.6	203.2
10	250	273.1	381.0	159.0	216.0	254.0	127.0	515.0	391.0	762.0	508.0	324.0	127	254
12	300	323.9	457.0	190.0	254.0	303.0	152.0	619.0	467.0	914.0	610.0	381.0	152.4	254
14	350	355.6	533.0	22.0	279.0	356.0	165.0	711.0	533.0	1067.0	711.0	413.0	152.4	305.0
16	400	406.4	610.0	254.0	305.0	406.0	178.0	813.0	610.0	1219.0	813.0	470.0	152.4	305.0
18	450	457.2	686.0	286.0	343.0	457.0	203.	914.0	686.0	1372.0	914.0	533.0	152.4	305.0
20	500	508	762.0	318.0	381.0	508.0	229.0	1016.0	762.0	1524.0	1016.0	584.0	152.4	305.0
22	550	559	838.0	343.0	419.0	559.0	254.0	1118.0	838.0	1676.0	1118.0	614.0	152.4	305.0
24	600	610	914.0	381.0	432.0	610.0	267.0	1219.0	914.0	1829.0	1219.0	692.0	152.4	305.0
26	650	660	991.0	406.0	495.0	660.0	267.0	—	—	—	—	—	—	—
28	700	711	1067.0	438.0	521.0	771.0	267.0							
30	750	762	1143.0	470.0	589.0	762.0	267.0							
32	800	813	1219.0	502.0	597.0	813.0	267.0							
34	850	864	1295.0	533.0	635.0	864.0	267.0							
36	900	914	1372.0	565.0	673.0	914.0	267.0							

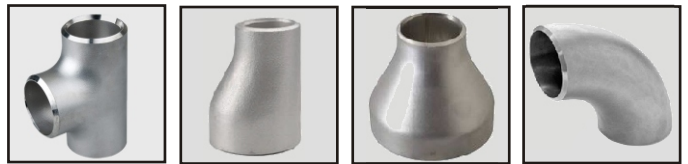



Pacific Steel Overseas

SOCKET WELD FITTING TO ANSI B-16.11

90° ELBOWS

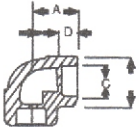

TEE

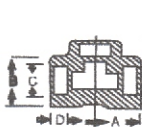

45° ELBOWS

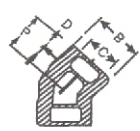

UNION

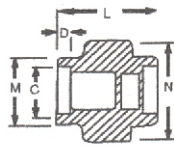

COUPLING

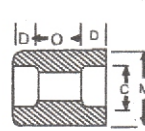

REDUCER

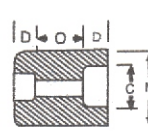

HALF COUPLING

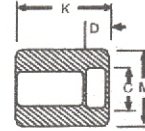

CAP

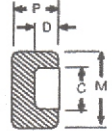

NOM BORE	PIPE O.D.	3000 LBS.									COMMON FACTORS				6000 LBS.				
		A max.	B max.	K	J	L	M	N	P	Q	C min.	D min.	O min.	O min.	A	B	M	K	N
1/8"	10.3	22	18.5	26	16	40	17.3	32	17.5	10	10.7	10	5	8	22	22	20	25	46
1/4"	13.7	22	22	26	18	43	21.2	32	17.5	10	14.1	10	5	8	27	25	24	25	51
3/8"	17.2	25	25	26	19	48	25.4	36	19	10	17.6	10	3	9	27	28	28	26	60
1/2"	21.3	27	32	30	21	51	31	43	22	10.	21.7	10.	6	13	31	34	34	30	72
3/4"	26.7	34	38	36	24	57	37	50	25	13	27	13	6	13	37	42	41	35	80
1"	33.4	37	46	40	25	64	45.2	60	27	13	33.8	13	9	17	42	50	50	40	94
1 1/4"	42.2	42	56	40	29	70	55	70	30	13	42.6	13	9	17	47	59	58	41	100
1 1/2"	48.3	47	62	40	30	79	61.4	78	32	13	48.7	13	9	17	53	67	66	43	122
2"	60.3	56	75	52	37	89	75	95	38	13	61.2	16	15	23	59	84	83	55	
2 1/2"	73.02	60	92	52	48	114	91.3	125	38	16	73.8	16	14	24		102		56	
3"	89.00	76	110	52	51	127	108.8	140	44	16	89.8	16	14	24		121		58	
4"	114.50	88	137	58		150	136.9		48	19	115.5	19	14	24		152		64	

FORGED SCREWED FITTING TO ANSI B-16.11 3000/6000 LBS. THREADED TO ASA B-2.1

90° ELBOWS

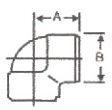

TEE

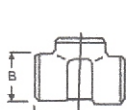

45° ELBOWS



UNION

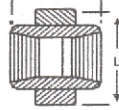

COUPLING

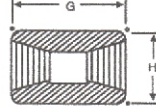

PIPE CAP

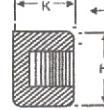

BUSHING

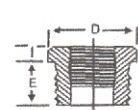

CAP PLUG

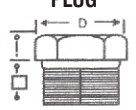

(DIMENSIONS IN MM)

NOM BORE	PIPE O.D.	3000 LBS.						COMMON FACTORS						6000 LBS.					
		A	B	C	G	H	K	D	E	F	I	J	L	A	B	C	G	H	K
1/8"	10.3	21	22	17	32	16	19	11	10	40	—	6	—	25	25	19	32	22	—
1/4"	13.7	25	25	19	35	19	25	16	11	43	3	6	32	29	33	22	35	25	27
3/8"	17.2	29	33	22	38	22	25	17.5	13	48	4	8	38	33	38	25	38	32	27
1/2"	21.3	33	38	25	48	29	32	22	15	51	5	8	46	38	46	29	48	38	33
3/4"	26.7	38	46	29	51	35	37	27	16	57	6	10	51	44	56	33	51	44	38
1"	33.4	44	56	33	60	44	41	35	19	64	6	10	60	51	62	35	60	57	43
1 1/4"	42.2	51	62	35	67	57	44	44.5	21	70	7	14	72	60	75	43	67	64	46
1 1/2"	48.3	60	75	43	79	64	44	51	21	79	8	16	80	64	84	44	79	76	48
2"	60.3	64	84	45	86	76	48	63.5	22	88	9	17	94	83	102	52	86	92	51
2 1/2"	73.02	83	102	52	92	92	60	76	27	118	10	21	122	95	121	64	92	108	64
3"	89.00	95	121	64	108	108	65	89	29	121	10	65	140	106	146	79	108	127	68
4"	114.50	114	152	79	121	140	68	117.5	32	150	13	25	180	114	152	79	121	159	75

DIMENSION AND OTHERS SPECIFICATION AS PER CUSTOMERS REQUIREMENTS ARE AVAILABLE ON REQUEST



Pacific Steel Overseas

STAINLESS STEEL PIPES AND TUBES CHEMICAL & PHYSICAL PROPERTIES

Grade	Tensile Test									Tensile Test				
	C	S	Mn	P Max.	P Max.	Cr	Mo	Ni	Other Elements	Tensile Strength	Yield Point Strength	Elongation in 2 or 50 mm min%		
										kg./mm ²	kg./mm ²	Curved strip and Tubular Specimens		
										min	min	Longitudinal	Transverse	
												≤ 5/16in	≤ 5/16in	≤ 5/16in
TP304	0.08 max	0.75 max	2.0 max	0.040	0.030	18.0-20.0	—	8.00-11.0	—	52.52	20.90	35	—	25
TP304L	0.035 max	0.75 max	2.0 max	0.040	0.030	18.0-20.0	—	8.00-13.0	—	49.46	17.34	35	—	25
TP309S	0.08 max	0.75 max	2.0 max	0.045	0.030	22.0-24.0	0.75 max	12.0-15.0	—	52.52	20.90	35	—	25
TP310S	0.08 max	0.75 max	2.0 max	0.045	0.030	24.0-26.0	0.75 max	19.0-22.0	—	52.52	20.90	35	—	25
TP3016	0.08 max	0.75 max	2.0 max	0.040	0.030	16.0-18.0	2.00-3.00	11.0-14.0	—	52.52	20.90	35	—	25
TP316L	0.035 max	0.75 max	2.0 max	0.040	0.030	16.0-18.0	2.00-3.00	10.0-15.0	—	49.46	17.34	35	—	25
TP317	0.08 max	0.75 max	2.0 max	0.040	0.030	18.0-20.0	3.00-4.00	11.0-14.0	—	52.52	20.90	35	—	25
TP317L	0.035 max	0.75 max	2.0 max	0.040	0.030	18.0-20.0	3.00-4.00	11.0-15.0	—	52.52	20.90	35	—	25
TP321	0.08 max	0.75 max	2.0 max	0.040	0.030	17.0-20.0	—	9.0-18.0	Ti5xC%-0.70	52.52	20.90	35	—	25
TP321H	0.04 max	0.75 max	2.0 max	0.040	0.030	17.0-20.0	—	9.0-13.0	Ti4C%-0.60	52.52	20.90	35	—	25
TP329	0.10 max	1.00 max	2.0 max	0.040	0.030	25.0-30.0	1.00-2.00	3.00-6.00	—	—	—	—	—	—
TP347	0.08 max	0.75 max	2.0 max	0.040	0.030	17.0-20.0	—	9.0-13.0	Nb+TA10xC%-1.00	52.52	20.90	35	—	25
TP347H	0.04-0.10	0.75 max	2.0 max	0.040	0.030	17.0-20.0	—	9.0-13.0	Nb+TA8C%-1	52.52	20.90	35	—	25

CARBON STEEL, ALLOY STEEL, LOW TEMP, PIPE AND TUBES SPECIFICATION

CHEMICAL ANALYSIS									MECHANICAL PROPERTIES			SPECIFIC REQUIREMENT				
									TENSILE STRENGTH	YIELD STRENGTH	ELONGATION					
SPECIFICATION	WT	C %	Mn %	P % MAX	S % MAX	Si %	Cr %	Mo %	Mpa	Mpa	50mm MIN Longitudinal	—				
ASTM A 53/A	AW	0.25MAX	0.95 MAX	0.050	0.060	—	—	—	331MIN	207MIN	36	—				
ASTM A 53/B	AW	0.30MAX	1.20MAX	0.050	0.060	—	—	—	413MIN	240MIN	29.5	Cr	Mo	Cu	Ni	Va
ASTM A 106/A	AW	0.25MAX	0.27-0.93	0.025	0.025	0.10MIN	0.40MAX	0.15MAX	330MIN	205MIN	35/28	0.40	0.15	0.40	0.40	0.08
ASTM A 106/B	AW	0.30MAX	0.29-1.06	0.025	0.025	0.10MIN	0.40MAX	0.15MAX	415MIN	240MIN	30/22	Five elements not to exceed 1%				
ASTM A 106/C	AW	0.35MAX	0.29-1.06	0.025	0.025	0.10MIN	0.40MAX	0.15MAX	485MIN	275MIN	30/22					
ASTM A 335/p1	AW	0.10-0.20	0.30-0.80	0.025	0.025	0.10-0.50	—	0.44-0.65	380MIN	205MIN	30/22					
ASTM A 335/p2	AW	0.10-0.20	0.30-0.61	0.025	0.025	0.10-0.30	0.50-0.81	0.44-0.65	380MIN	205MIN	30/22					
ASTM A 335/p5	AW	0.15MAX	0.30-0.60	0.025	0.025	0.50MAX	4.00-6.00	0.45-0.65	415MIN	205MIN	30/22					
ASTM A 335/p9	AW	0.15MAX	0.30-0.60	0.025	0.025	0.25-1.00	8.00-10.00	0.09-1.10	415MIN	172MIN	30/22					
ASTM A 335/p11	AW	0.15MAX	0.30-0.60	0.025	0.025	0.50-1.00	1.00-1.50	0.44-0.65	415MIN	205MIN	30/22					
ASTM A 335/p12	AW	0.15MAX	0.30-0.61	0.025	0.025	0.50MAX	0.80-1.25	0.44-0.65	415MIN	205MIN	50/22					
ASTM A 335/p22	AW	0.15MAX	0.30-0.60	0.025	0.025	0.50MAX	1.90-2.60	0.87-1.13	415MIN	205MIN	30/22					
ASTM A 335/t1	MW	0.10-0.20	0.30-0.61	0.045	0.045	0.10-0.30	0.50-0.81	0.44-0.65	415MIN	205MIN	30/22	Hardness 85 HRB Max				
ASTM A 335/t5	MW	0.15MAX	0.30-0.60	0.030	0.030	0.50MAX	4.00-6.00	0.44-0.65	415MIN	205MIN	30/22	Hardness 85 HRB Max				
ASTM A 335/t11	MW	0.15MAX	0.30-0.60	0.030	0.030	0.50-1.00	1.00-1.50	0.44-0.65	415MIN	205MIN	30/22	Hardness 85 HRB Max				
ASTM A 335/t12	MW	0.15MAX	0.30-0.61	0.045	0.045	0.50MAX	0.80-1.25	0.44-0.65	415MIN	205MIN	30/22	Hardness 85 HRB Max				
ASTM A 335/t22	MW	0.15MAX	0.30-0.60	0.030	0.030	0.50MAX	1.90-2.60	0.87-1.13	415MIN	205MIN	30/22	Hardness 85 HRB Max				
ASTM A 335/1	AW	0.30MAX	0.40-1.06	0.025	0.025	—	—	—	380MIN	205MIN	25/20	IMPACT AS -50F				
ASTM A 335/6	AW	0.30MAX	0.29-1.06	0.025	0.025	0.10MIN	—	—	415MIN	240MIN	30/22	FOR 40x10J / 18 / 14				
ASTM A 334/1	AW	0.30MAX	0.40-1.06	0.025	0.025	—	—	—	380MIN	205MIN	35/28	-50F 40x10J / 18 / 14				
ASTM A 334/6	MW	0.30MAX	0.29-1.06	0.025	0.025	0.10MIN	—	—	415MIN	240MIN	30/22	90 HRB MAX				

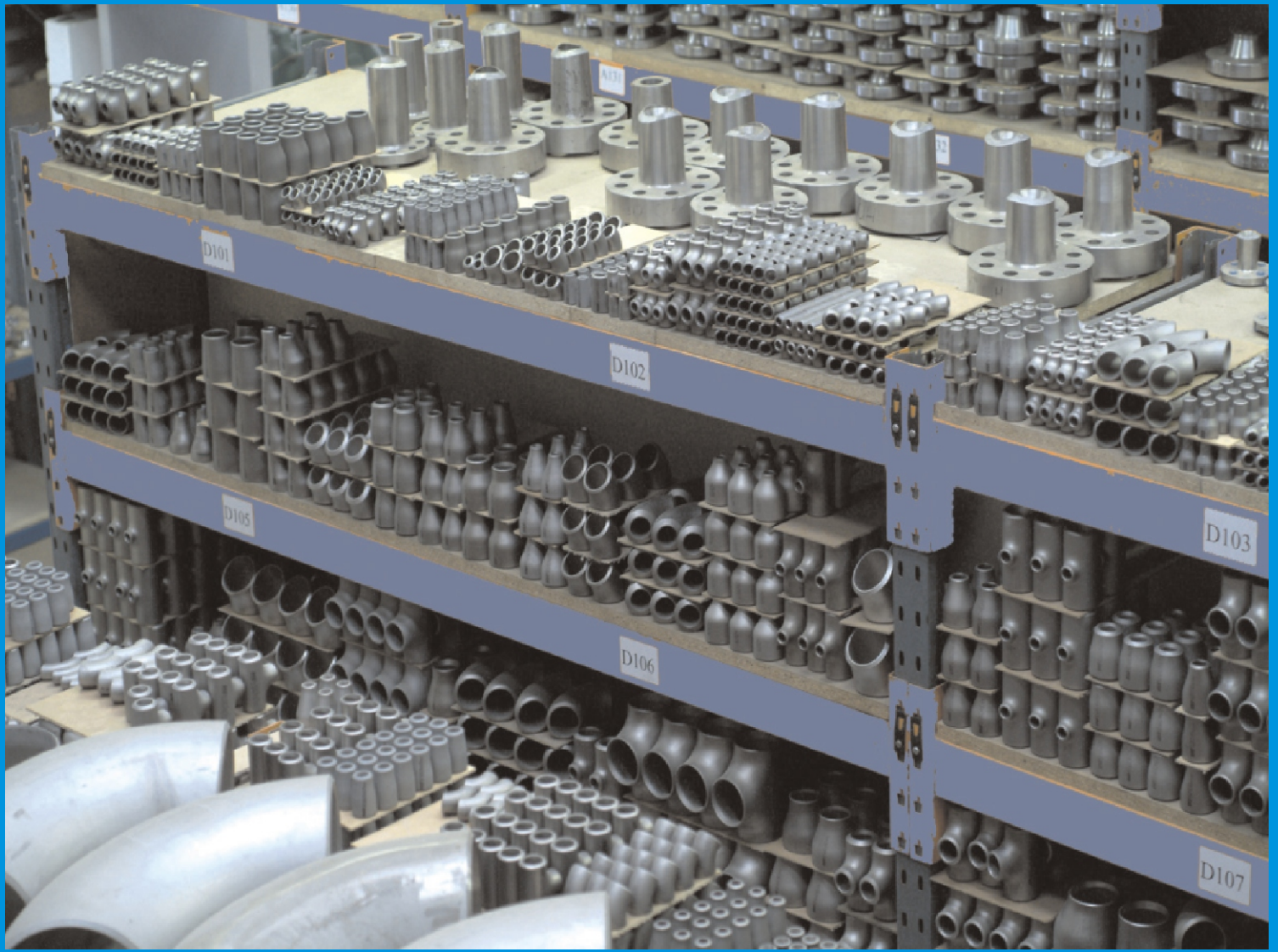

Pacific Steel Overseas

Corporate Office :
1, Narayan Avenue,
Ganubakri Khancho, Lakkadpitha,
Vadodara-390 001.
(Gujarat) INDIA.

Tel. : +91-265-2419828,
Fax : +91-265-2419827,
Email : export@pacificsteel.in
sales@pacificsteel.in
Website : www.pacificsteel.in